

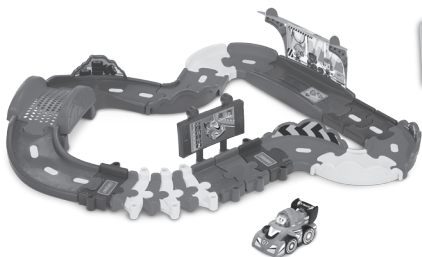

vtech®

Quick Start Guide



**Toot-Toot
Drivers®**

V Racers Pit Stop

By reducing the quantity of paper used for our Manuals, we aim to reduce our environmental impact and contribute to the preservation of the environment. The full version of the Instruction Manual is available online through the following links or by scanning the QR code.



For UK
vtech.co.uk/manuals



For AUS/NZ
vtech.com.au/support/product_manuals

INCLUDED IN THE PACKAGE



One Racer

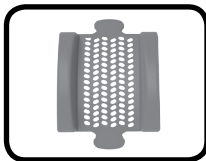

One Bridge

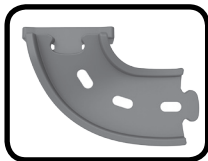

One Big Track-Right



One Adaptor Track Male

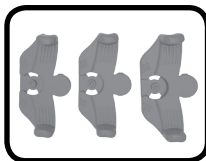

Three 1/8 Track

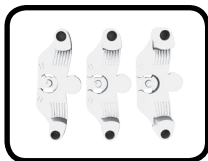

Three 1/8 Rotatable Track

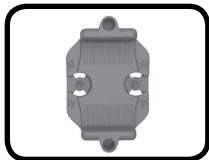

One 1/4 Track Female



One 1/4 Track Male



One Adaptor Track Female



One Billboard



Three Half Circle Tracks



One 90 Degree Track Convex

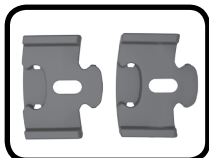

Two 1/3 Track Straight

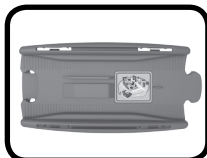

One Book Page Track



One Plastic Pit Stop



One 60 Degree
Track Convex



One 60 Degree
Track Convex

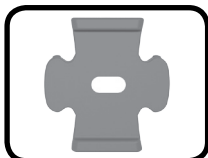

One Half Length
Track Convex

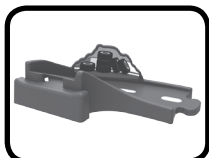

One Big Track Left



One Quick Start Guide

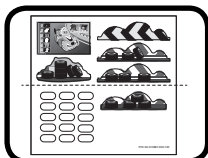

One label sheet

WARNING

All packing materials such as tape, plastic sheets, packaging locks, removable tags, cable ties, cords and packaging screws are not part of this toy, and should be discarded for your child's safety.

NOTE

Please save this Quick Start Guide as it contains important information.

INSTRUCTIONS

WARNING:

Adult assembly required for battery installation.
Keep batteries out of reach of children.

Battery Removal and Installation – Racer

1. Make sure the unit is turned OFF.
2. Locate the battery cover on the bottom of the unit. Use a screwdriver to loosen the screw and then open the battery cover.
3. If used batteries are present, remove these batteries from the unit by pulling up on one end of each battery.
4. Install 1 new AAA (AM-4/LR03) battery following the diagram inside the battery box. (For best performance, alkaline batteries or fully charged Ni-MH rechargeable batteries are recommended.)
5. Replace the battery cover and tighten the screw to secure.

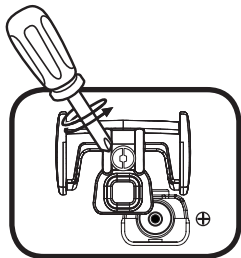



IMPORTANT: BATTERY INFORMATION

- Insert batteries with the correct polarity (+ and -).
- Do not mix old and new batteries.
- Do not mix alkaline, standard (carbon-zinc) or rechargeable batteries.
- Only batteries of the same or equivalent type as recommended are to be used.
- Do not short-circuit the supply terminals.
- Remove batteries during long periods of non-use.
- Remove exhausted batteries from the toy.
- Dispose of batteries safely. Do not dispose of batteries in fire.

RECHARGEABLE BATTERIES

- Remove rechargeable batteries (if removable) from the toy before charging.
 - Rechargeable batteries are only to be charged under adult supervision.
 - Do not charge non-rechargeable batteries.
- 

Disposal of batteries and product



The crossed-out wheellie bin symbols on products and batteries, or on their respective packaging, indicates they must not be disposed of in domestic waste as they contain substances that can be damaging to the environment and human health.



The chemical symbols Hg, Cd or Pb, where marked, indicate that the battery contains more than the specified value of mercury (Hg), cadmium (Cd) or lead (Pb) set out in the Batteries and Accumulators Regulation.

The solid bar indicates that the product was placed on the market after 13th August, 2005.

 Please dispose of your product and batteries responsibly.

In the UK, give this toy a second life by disposing of it at a small electricals collection point* so all of its materials can be recycled.

Learn more at:

www.vtech.co.uk/recycle

www.vtech.com.au/sustainability

* Visit www.recyclenow.com to see a list of collection points near you.

LABEL APPLICATION

Please stick the labels to the play set securely as indicated on the following page:

1

1	07
2	6
3	33
4	6
5	77
6	2

2

3

4

5

6

7

8

9

10

11

12

13

14

15

16

17

18

19

20

21

P/N: 92-013887-000-100

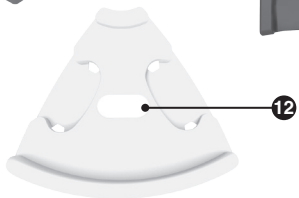
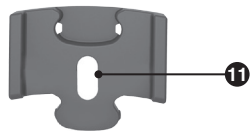
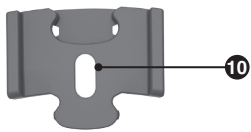
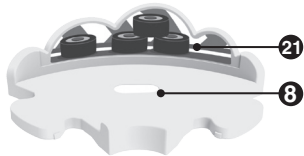

8

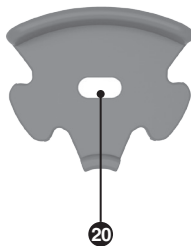
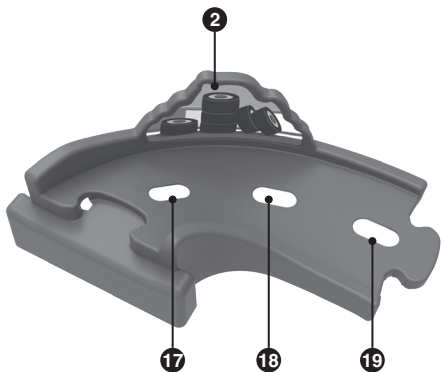
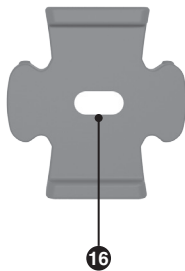
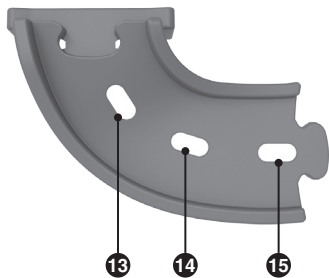

ASSEMBLY INSTRUCTIONS

With the **VTech® Toot-Toot Drivers® V Racers Pit Stop**, safety comes first. To ensure your child's safety, adult assembly is required.

Assemble and attach the track components following the steps as below:

1. Attach the Bridge to the Big Track-Right and Big Track-Left.

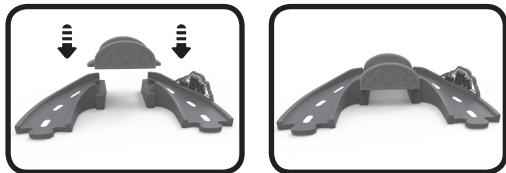

2. Attach the $\frac{1}{4}$ Track-Male to the $\frac{1}{4}$ -Track-Female. You will hear a clicking sound. Then insert the Billboard in the holes of the $\frac{1}{4}$ -Track-Male and the $\frac{1}{4}$ -Track-Female.

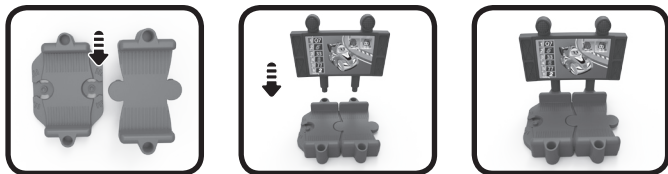

3. Fold the Plastic Pit Stop wings at a 90 ° angle, then fold the top of the Plastic Pit Stop to connect them, and finally insert them into the Book Page Track



All pieces have now been assembled. Please refer to the below configuration to build the track.

Main Configuration

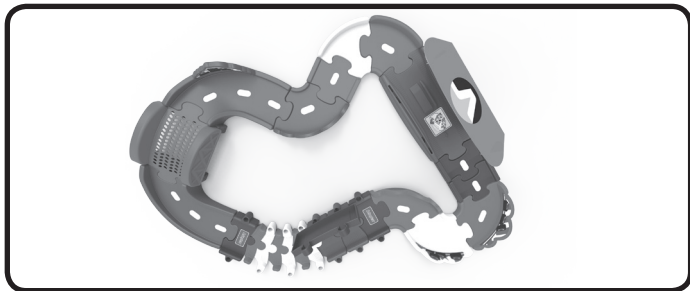

CARE & MAINTENANCE

1. Keep the unit clean by wiping it with a slightly damp cloth.
2. Keep the unit out of direct sunlight and away from any direct heat sources.
3. Remove the batteries if the unit will not be in use for an extended period of time.
4. Do not drop the unit on hard surfaces and do not expose the unit to moisture or water.
5. If the unit stops working or malfunctions, install a new set of batteries.

PRODUCT WARRANTY/ CONSUMER GUARANTEES

UK Customers:

Read our complete warranty policy online at vtech.co.uk/warranty.

Australian Customers:

VTECH ELECTRONICS (AUSTRALIA) PTY LIMITED – CONSUMER GUARANTEES

Under the Australian Consumer Law, a number of consumer guarantees apply to goods and services supplied by VTech Electronics (Australia) Pty Limited. Please refer to vtech.com.au/consumerguarantees for further information.

Contact VTech

Tel: 0330 678 0149 (from UK)
+44 330 678 0149 (outside UK)
1800 862 155 (Aus) / 0800 400 785 (NZ)

www.vtech.co.uk
www.vtech.com.au